

-31

No 870 of Do. Co. Land

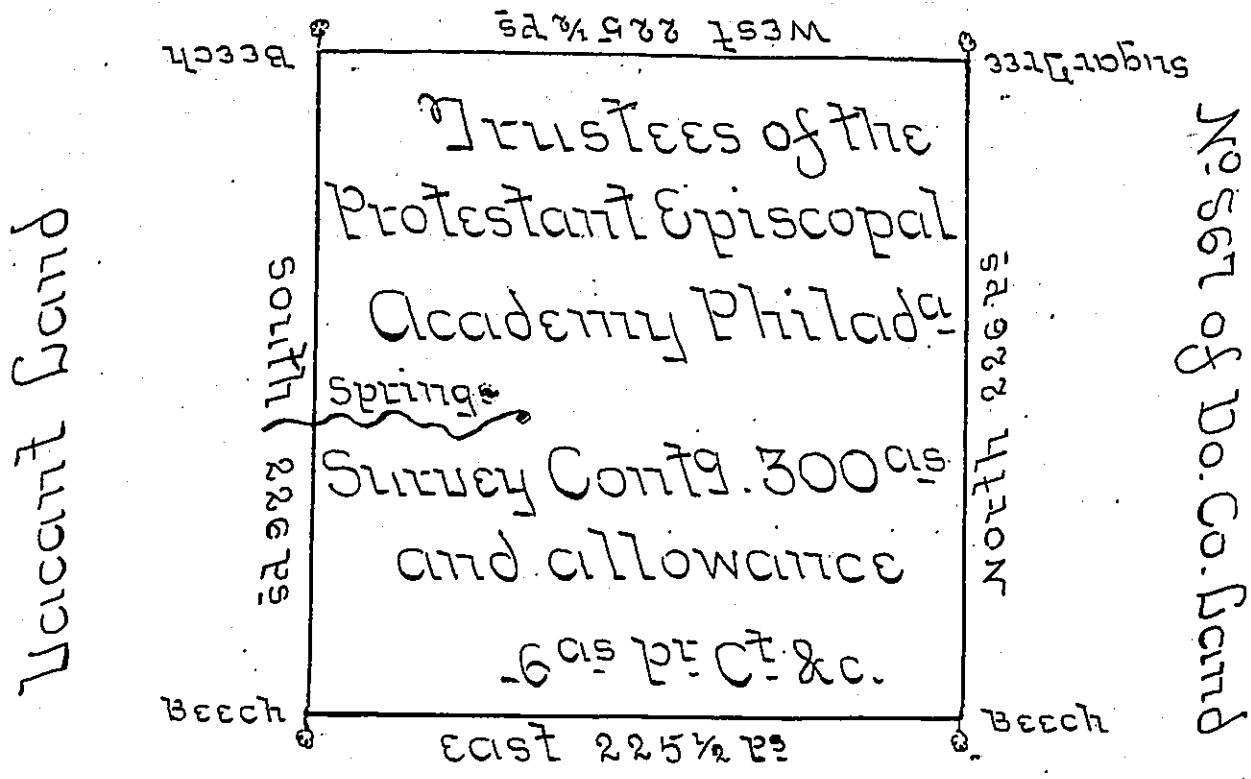

No 870 of Do. Co. Land

A Draught of a tract of land situated in the late purchase on the head waters of the East branch of Pine creek and about twenty two miles distant from the West branch of Susquehanna, surveyed for the Trustees of the Protestant Episcopal Academy of Philadelphia September one thousand seven hundred & eighty eight on a Warrant numbered eight hundred and fifty four ^{dated 30 June 1787} containing three hundred acres and allowance -

Saml Edmiston

U.S.

John Lukens Esq }
 Secy }

IN TESTIMONY that the above is a copy of the original remaining on file in the Department of Internal Affairs of Pennsylvania, made conformably to an Act of Assembly approved the 16th day of February, 1833, I have hereunto set my Hand and caused the Seal of said Department to be affixed at Harrisburg, this eighteenth day of October 1904.

George R. Brown
 Secretary of Internal Affairs.